

CLIFTON

2 bedroom + 2 bath, 1047 sq. ft

Suite 601

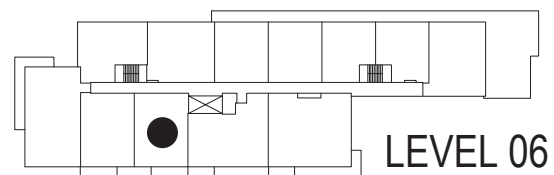

This plan is not to be scaled and is subject to architectural review and revisions to maintain the high standards of this development without notice. All details are approximate and subject to change without notice in order to comply with building site conditions and municipal, structural and vendor and/or architectural requirements. The location, size and type of windows and exterior building elements such as balconies and terraces, if any, may vary without notice. Purchasers are specifically advised that dimensions and square footages may change on completion of the condominium and all figures are subject to Tarion Bulletin Number 22. Furniture, kitchen islands and dashed wall are representational only and do not form any part of any contract document. Floorplans may be mirror image of what is shown. Column sizes shown are average for the building and will vary in size. E. & O.E. Please refer to the agreement.



TVMGROUP
Integrated Real Estate Company